

# Hep<sub>2</sub>O

Nuova generazione del sistema  
push-fit in Polibutilene



**Hep<sub>2</sub>O**  
Next Generation

[www.hep2o.it](http://www.hep2o.it)

**wavin**

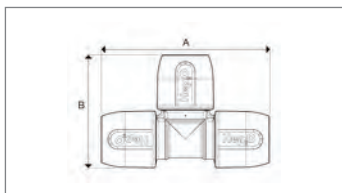
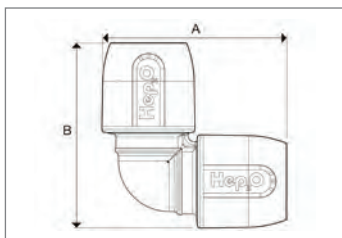
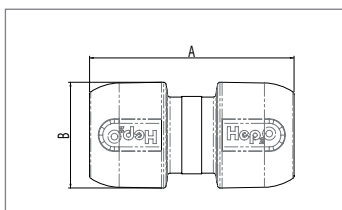
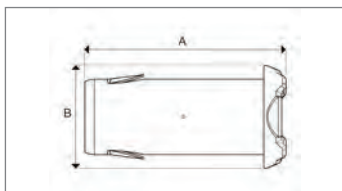
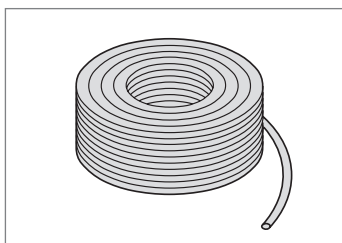
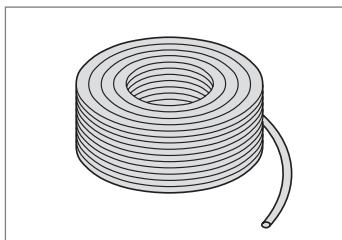
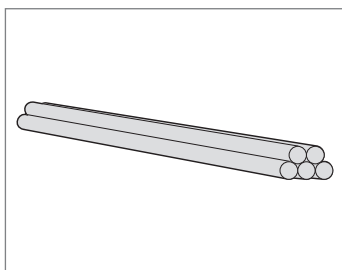

**SISTEMI AD INNESTO RAPIDO DI COLORE BIANCO PER IMPIANTI SANITARI E TERMICI**

**TUBO PB BARRIER IN BARRE**

CODICE	MINIMO VENDITA	D	d	L	H	CODICE FORNITORE	U.M.	€
0521068	240	15	11	6 m		AF503B	MT	2,557
0521073	120	22	18	6 m		AF504B	MT	4,794
0521077	72	28	22	6 m		AF499B	MT	9,089

**TUBO PB BARRIER NUDO IN ROTOLO**

0521065	100	10	6,8	100 m		AF413	MT	1,915
0521070	25	15	11	25 m		AF909B	MT	2,510
0521071	50	15	11	50 m		AF905B	MT	2,510
0521069	100	15	11	100 m		AF505B	MT	2,510
0521074	25	22	18	25 m		AF906B	MT	4,723
0521075	50	22	18	50 m		AF506B	MT	4,723
0521078	25	28	22	25 m		AF910B	MT	8,934

**TUBO PB BARRIER PREISOLATO IN ROTOLO - GUAINA BLU**

0521060	50	15	11	50 m		AF105B	MT	3,640
0521059	100	15	11	100 m		AF109B	MT	3,640
0521061	25	22	18	25 m		AF106B	MT	5,996
0521062	50	22	18	50 m		AF108B	MT	5,996
0521063	25	28	22	25 m		AF110B	MT	9,541

**MANICOTTO DI SOSTEGNO IN ACCIAIO**

CODICE	MINIMO VENDITA	D	d	A	B	CODICE FORNITORE	U.M.	€
0520986	20	10	6,8	27	10	AF958	NR	0,618
0520988	50	15	11	29	15	AF947	NR	0,450
0520989	50	22	18	32	22	AF934	NR	0,605
0520990	20	28	22	36	28	AF570	NR	1,013

**RACCORDO DIRITTO IN PB**

0521017	5	10		66	23	AF516	NR	3,049
0521019	10	15		72	29	AF507	NR	3,054
0521020	10	22		78	41	AF508	NR	4,308
0521021	5	28		85	50	AF707	NR	6,869

**RACCORDO A GOMITO IN PB**

0520999	10	10		48	48	AF519	NR	4,186
0521000	10	15		59	59	AF511	NR	3,632
0521001	10	22		71	71	AF512	NR	5,491
0521002	5	28		82	82	AF711	NR	8,179

**RACCORDO A "T" IN PB**

0520994	5	10		75	48	AF520	NR	6,470
0520996	10	15		88	59	AF521	NR	5,364
0520997	10	22		101	71	AF522	NR	7,236
0520998	5	28		114	82	AF721	NR	10,235

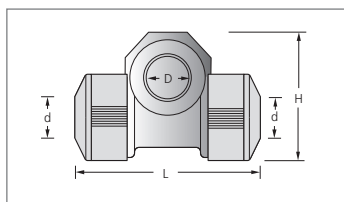
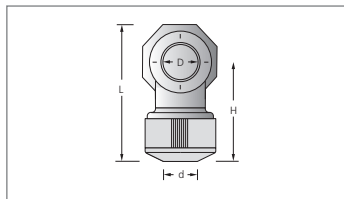
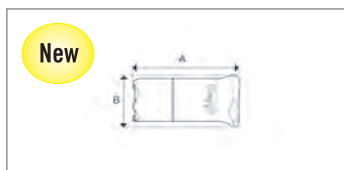
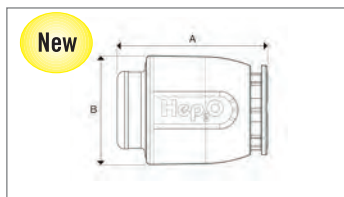
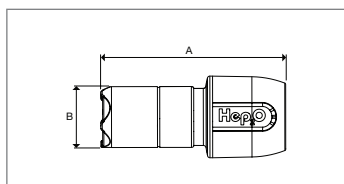
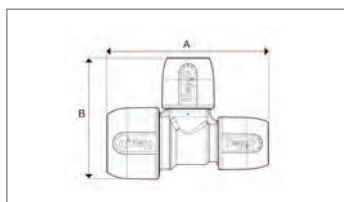
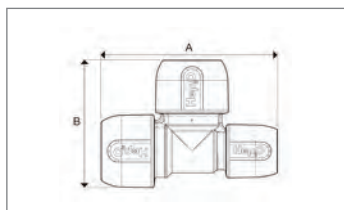
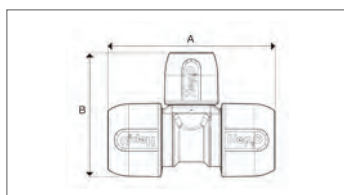

## SISTEMI AD INNESTO RAPIDO DI COLORE BIANCO PER IMPIANTI SANITARI E TERMICI

## RACCORDO A "T" RIDOTTO IN PB

CODICE	MINIMO VENDITA	D	D	A	B	CODICE FORNITORE	U.M.	€
0521042	5	22	15	96	68	AF524	NR	7,236
0521043	5	28	22	104	80	AF724	NR	10,699
0521039	5	15	10	92	68	AF531	NR	6,382

## RACCORDO A "T" RIDOTTO IN PB

0521038	5	15	10	80	55	AF532	NR	7,575
0521041	5	22	15	92	69	AF525	NR	7,236
0521040	5	22	10	84	65	AF533	NR	10,331
0521036	5	28	22	104	80	AF725	NR	10,699

## RACCORDO A "T" RIDOTTO IN PB

0521035	5	22	15	98	71	AF523	NR	7,236
0521037	5	28	22	114	84	AF723	NR	11,201

## RIDUTTORE IN PB

0521047	10	15	10	62	23	AF510	NR	5,852
0521049	10	22	15	67	29	AF509	NR	3,871
0521050	10	28	22	75	40	AF709	NR	5,377

## TAPPO FINALE IN PB

CODICE	MINIMO VENDITA	D	A	B	H	CODICE FORNITORE	U.M.	€
0625535	5	10	37	23		AF614	NR	4,274
0625536	5	15	41	29		AF615	NR	4,274
0625537	5	22	44	41		AF616	NR	5,395
0625538	5	28	50	47		AF617	NR	5,600

## TAPPO PER RACCORDO IN PB

0625539	10	10	50	10		AF618	NR	1,577
0625540	10	15	54	15		AF619	NR	1,032
0625541	10	22	55	22		AF620	NR	1,032
0625542	10	28	60	28		AF621	NR	1,284

## RACCORDO TERMINALE DI TESTA, IN OTTONE

0521044	5	1/2	15	62	68	AF626	NR	8,390
---------	---	-----	----	----	----	-------	----	-------

## RACCORDO TERMINALE DI PASSAGGIO, IN OTTONE

0521016	5	1/2	15	62	48	AF627	NR	11,990
---------	---	-----	----	----	----	-------	----	--------

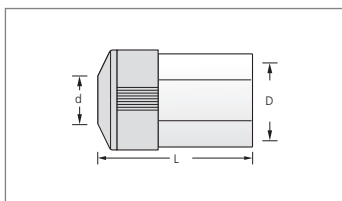

SISTEMI AD INNESTO RAPIDO DI COLORE BIANCO PER IMPIANTI SANITARI E TERMICI								
RACCORDO DIRITTO FEMMINA, IN OTTONE								
CODICE	MINIMO VENDITA	D	d	H		CODICE FORNITORE	U.M.	€
0521024	10	3/8	15	49		AF633	NR	6,054
0521023	10	1/2	15	49		AF631	NR	5,335
0521025	5	1/2	22	53		AF653	NR	8,461
0521026	5	3/4	22	53		AF657	NR	7,869
0521027	5	1	28	67		AF671	NR	12,248

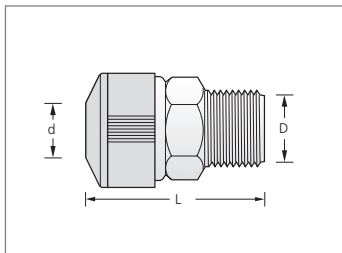

RACCORDO DIRITTO MASCHIO, IN OTTONE								
0521030	10	3/8	15	46		AF632	NR	4,477
0521029	10	1/2	15	46		AF630	NR	4,519
0521031	5	1/2	22	48		AF652	NR	7,037
0521032	5	3/4	22	48		AF655	NR	6,546
0521033	2	1	28	61		AF670	NR	11,956

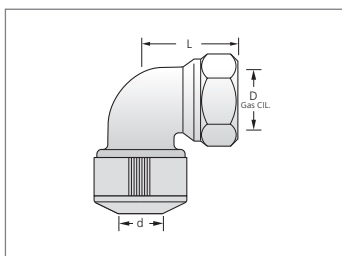

RACCORDO A GOMITO FEMMINA, IN OTTONE								
0521008	10	3/8	15	31		AF638	NR	7,134
0521007	10	1/2	15	31		AF636	NR	6,926
0521005	5	1/2	22	39		AF656	NR	11,304
0521006	5	3/4	22	43		AF659	NR	10,502
0521004	2	1	28	45		AF676	NR	18,602

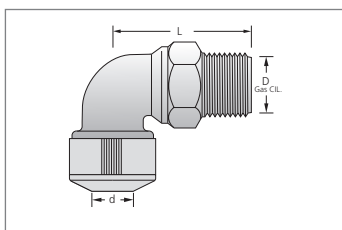

RACCORDO A GOMITO MASCHIO, IN OTTONE								
0521013	10	3/8	15	43		AF637	NR	7,738
0521014	10	1/2	15	34		AF635	NR	6,630
0521011	5	1/2	22	45		AF654	NR	11,201
0521012	5	3/4	22	43		AF658	NR	10,502
0521010	2	1	28	47		AF675	NR	18,079

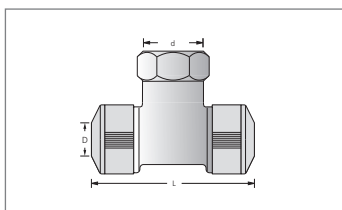

RACCORDO A T FEMMINA, IN OTTONE								
0521034	5	1/2	15	62		AF639	NR	9,521

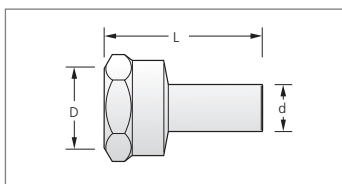

ADATTATORE FEMMINA, IN OTTONE								
0520970	10	1/2	15	47		AF540	NR	4,308
0520971	10	3/4	22	49		AF541	NR	6,376
0520969	10	1	28	55		AF741	NR	9,948

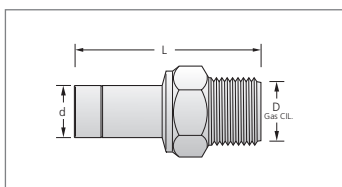

ADATTATORE MASCHIO, IN OTTONE								
0520972	10	1/2	15	50		AF542	NR	4,181
0520973	10	3/4	22	53		AF543	NR	6,757

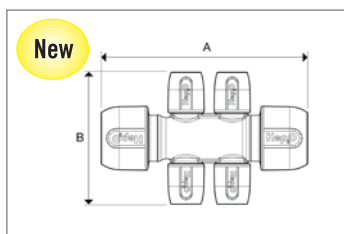
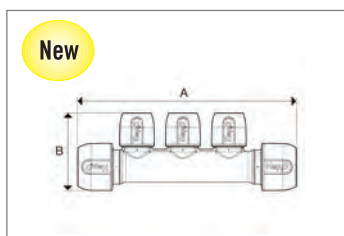
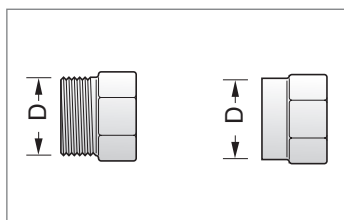
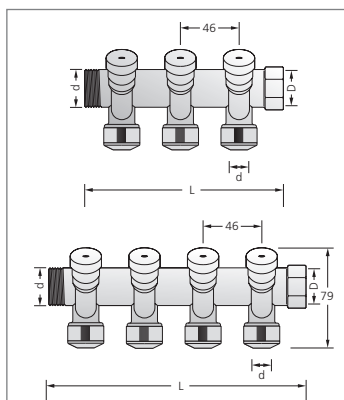
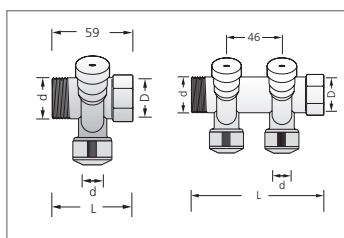

## SISTEMI AD INNESTO RAPIDO DI COLORE BIANCO PER IMPIANTI SANITARI E TERMICI

## COLLETORE CON RUBINETTI A UNA VIA, IN OTTONE NICHELATO

CODICE	MINIMO VENDITA	D	D	L	H	CODICE FORNITORE	U.M.	€
0520977	2	3/4	15			AF991	NR	14,696
0520978	2	3/4	22			AF981	NR	15,135

## COLLETORE CON RUBINETTI A DUE VIE, IN OTTONE NICHELATO

0520979	2	3/4	15			AF992	NR	30,155
---------	---	-----	----	--	--	-------	----	--------

## COLLETORE CON RUBINETTI A TRE E QUATTRO VIE, IN OTTONE NICHELATO

CODICE	MINIMO VENDITA	D	D	TIPO	CODICE FORNITORE	U.M.	€
0520981	2	3/4	15	3 vie	AF993	NR	42,296
0520983	2	3/4	15	4 vie	AF994	NR	56,553

Completi di manopole con targhette reversibili, in alluminio, di identificazione delle utenze e del circuito asservito (C - F).

## TAPPI PER COLLETORE, IN OTTONE NICHELATO

0521056	4	3/4		F	cieco	AF665	NR	1,914
0521057	4	3/4		M	cieco	AF666	NR	2,210

## COLLETTORI LINEARI IN PB

CODICE	MINIMO VENDITA	D	d	VIE	ATTACCO	CODICE FORNITORE	U.M.	€
0625543	5	22	10	4	Doppio	AF764PLB	NR	19,709
0570455	5	22	15	2	Doppio	AF762PLB	NR	10,826
0570456	5	22	15	3	Doppio	AF763PLB	NR	15,684
0625544	5	22	10	4	Cieco	AF764PL	NR	19,709
0549976	5	22	15	2	Cieco	AF762PL	NR	10,826
0549977	5	22	15	3	Cieco	AF763PL	NR	15,684

## COLLETTORI A CROCE IN PB

0625545	5	22	10	2	Doppio	AF962	NR	9,813
0625546	5	22	10	4	Doppio	AF964	NR	15,684
0625547	5	22	10	2	Cieco	AF962PL	NR	9,410
0625548	5	22	10	4	Cieco	AF964PL	NR	15,045

## CASSETTA PER COLLETORE, IN PLASTICA

CODICE	MINIMO VENDITA	L	I	H	CODICE FORNITORE	U.M.	€
0625549	1	300	250	95	AF692	NR	18,374
0625550	1	400	250	95	AF693	NR	23,926
0625551	1	480	250	95	AF694	NR	29,478
0625552	1	Coppia di staffe per uscite dal basso			AF695	NR	3,040

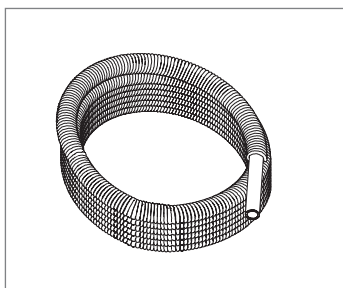
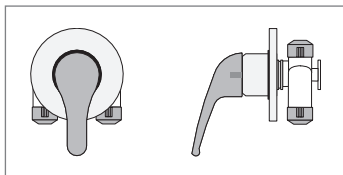
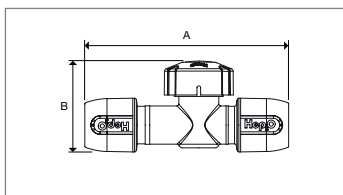
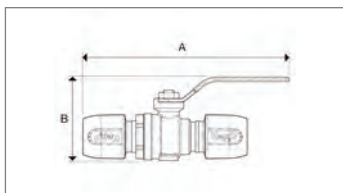
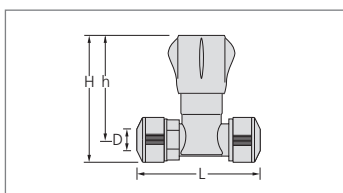
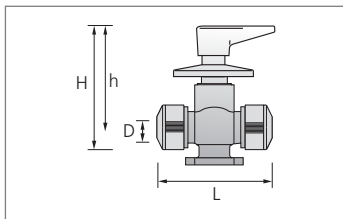
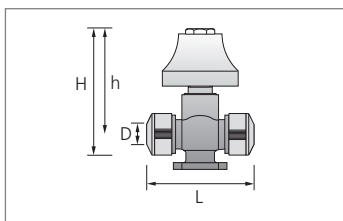

**SISTEMI AD INNESTO RAPIDO DI COLORE BIANCO PER IMPIANTI SANITARI E TERMICI**

**VALVOLA A SFERA DA INCASSO CON CODOLO, IN OTTONE**

CODICE	MINIMO VENDITA	D	H	h	L	CODICE FORNITORE	U.M.	€
0521086	1	15	98	78	85	AF640	NR	28,066
0521087	1	22	110	80	90	AF740	NR	33,525

**VALVOLA A SFERA DA INCASSO CON DEVIATORE, IN OTTONE**

0521084	1	15	98	78	85	AF650	NR	28,645
0521085	1	22	110	80	90	AF750	NR	33,958

**RUBINETTO DI ARRESTO, IN PB**

0521051	5	15	98	85	85	AF550	NR	18,005
0521052	5	22	113	92	98	AF551	NR	21,018

**VALVOLA A SFERA CON LEVA, IN OTTONE**

CODICE	MINIMO VENDITA	D	A	B		CODICE FORNITORE	U.M.	€
0521082	5	15	340	53		AF591	NR	35,108
0521083	5	22	340	53		AF592	NR	44,260

**RUBINETTO DI INTERCETTAZIONE, IN PB**

CODICE	MINIMO VENDITA	D	A	B	COLORE	CODICE FORNITORE	U.M.	€
0521053	5	15	112	50	Rosso/Blu	AF557	NR	12,318

**MISCELATORI IN OTTONE**

0520992	1	15				AF480	NR	93,623
---------	---	----	--	--	--	-------	----	--------

**SISTEMI SFILABILI AD INNESTO RAPIDO DI COLORE BIANCO PER IMPIANTI SANITARI E TERMICI**

**TUBO SLIDER IN PB PREINSERITO IN GUAINA CORRUGATA, IN ROTOLO**

CODICE	MINIMO VENDITA	D X D EXT	D	L	COLORE	CODICE FORNITORE	U.M.	€
0521153	50	15 x 25,0	11	50 m	Rosso	AF913B	MT	3,616
0521152	50	15 x 25,0	11	50 m	Blu	AF914B	MT	3,616
0521156	25	22 x 32,0	18	25 m	Rosso	AF903B	MT	5,793
0521154	25	22 x 32,0	18	25 m	Blu	AF904B	MT	5,793
0521157	50	22 x 32,0	18	50 m	Rosso	AF900B	MT	5,793
0521155	50	22 x 32,0	18	50 m	Blu	AF901B	MT	5,793

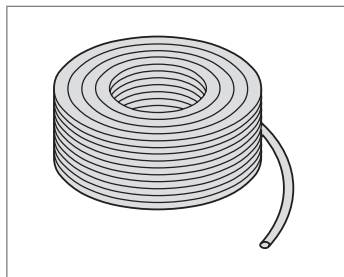
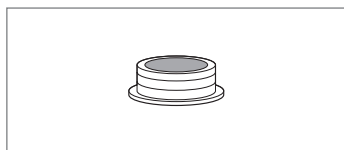
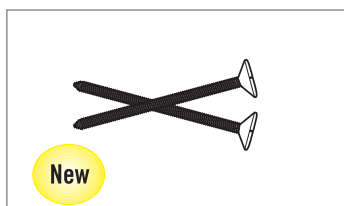
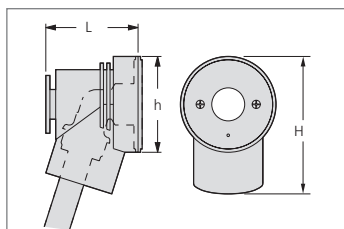
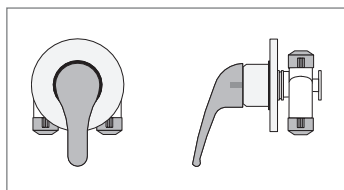
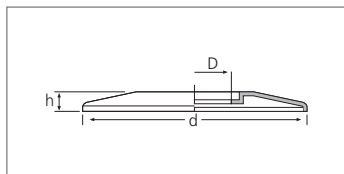
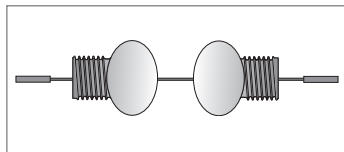
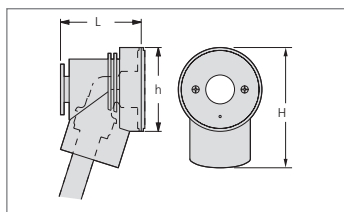
**SISTEMI SFILABILI AD INNESTO RAPIDO DI COLORE BIANCO PER IMPIANTI SANITARI E TERMICI**
**RACCORDO TERMINALE IN OTTONE E SCATOLA IN PLASTICA FLANGIATA**

CODICE	MINIMO VENDITA	L	H - h	D x d	COLORE	CODICE FORNITORE	U.M.	€
0521143	2	49,2	48 - 81,5	15 x 1/2	Verde	AF780	NR	11,429

Comprensivo di scatola murale in plastica, morsetto in gomma per innesto tubo corrugato, raccordo in ottone nichelato e viti di fissaggio.

**TESTINA GUIDA TUBO DOPPIA, IN OTTONE**

CODICE	MINIMO VENDITA	D				CODICE FORNITORE	U.M.	€
0521147	1	15				AF808	NR	3,405

**ROSONI PER TERMINALI SFILABILI**

CODICE	MINIMO VENDITA	D	d	H	TIPO	CODICE FORNITORE	U.M.	€
0521137	1	1/2	70	5	semplice	AF746	NR	1,332

**MISCELATORI IN OTTONE**

CODICE	MINIMO VENDITA	D				CODICE FORNITORE	U.M.	€
0520992	1	15				AF480	NR	93,623

**SCATOLA IN PLASTICA PER TERMINALE SFILABILE**

CODICE	MINIMO VENDITA	D	PER COD:	L	COLORE	CODICE FORNITORE	U.M.	€
0521138	1	12,7-15	AF780		Verde	AF0984	NR	2,715

**VITI DI FISSAGGIO PER TERMINALE SFILABILE**

0521159	1	15	AF780	34		AF0986	NR	0,183
---------	---	----	-------	----	--	--------	----	-------

**MORSETTO IN GOMMA PER TERMINALE SFILABILE**

CODICE	MINIMO VENDITA	D	PER COD:	CORRU-GATO:	COLORE	CODICE FORNITORE	U.M.	€
0521130	1	15	AF780	25 MM	Bianco	AF0987	NR	1,499

**SISTEMI AD INNESTO RAPIDO DI COLORE BIANCO PER IMPIANTI TERMICI**
**TUBO HEP THERM IN PB, PREISOLATO CON GUAINA ROSSA 6 MM, IN ROTOLO**

CODICE	MINIMO VENDITA	D	d	L		CODICE FORNITORE	U.M.	€
0521112	50	15	11	50 m		AF118	MT	2,986
0521108	100	15	11	100 m		AF128	MT	2,986
0521113	50	22	18	50 m		AF129	MT	4,794
0521114	50	28	22	50 m		AF122	MT	7,435

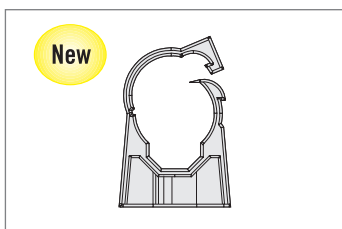
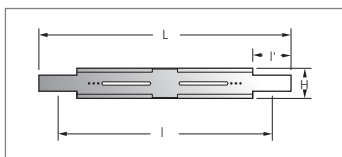
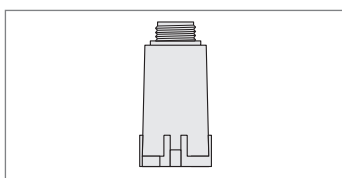
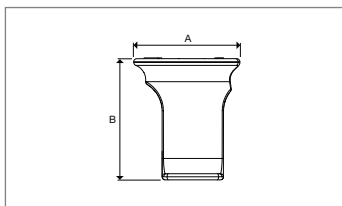
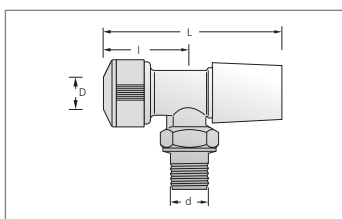
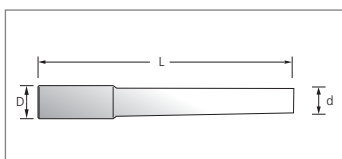
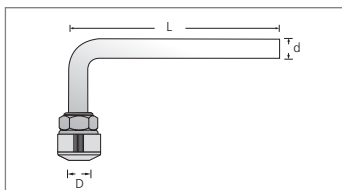
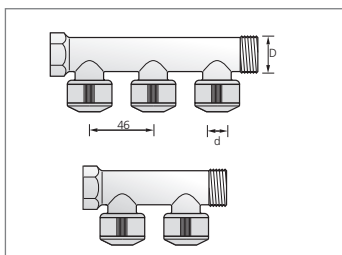

**SISTEMI AD INNESTO RAPIDO DI COLORE BIANCO PER IMPIANTI TERMICI**

**COLLETTORE PER RISCALDAMENTO, IN OTTONE**

CODICE	MINIMO VENDITA	D	d	L	VIE	CODICE FORNITORE	U.M.	€
0521097	2	3/4	15	110	2	AF762	NR	18,424
0521094	2	3/4	15	145	3	AF763	NR	22,457

**TERMINALE CON TRONCHETTO CURVO, IN OTTONE E RAME RICOTTO, NICHELATO**

0521104	5	15	14	190		AF727	NR	8,873
---------	---	----	----	-----	--	-------	----	-------

**TRONCHETTO DI RIDUZIONE, IN RAME**

CODICE	MINIMO VENDITA	D	d	L	I	CODICE FORNITORE	U.M.	€
0521107	10	15	14	190		AF624	NR	2,247

**COPPIA VALVOLA E DETENTORE, IN OTTONE NICHELATO**

0521102	1	15	1/2	80	35	AF576	NR	22,000
---------	---	----	-----	----	----	-------	----	--------

**ACCESORI PER SISTEMI AD INNESTO RAPIDO**

**ESTRATTORE IN PLASTICA**

CODICE	MINIMO VENDITA	D	A	B		CODICE FORNITORE	U.M.	€
0570451	10	10	31	39		AF610	NR	0,589
0570452	10	15	35	39		AF611	NR	0,589
0570453	10	22	45	41		AF612	NR	0,589
0570454	10	28	53	41		AF613	NR	0,589

**TAPPO COLLAUDO IMPIANTI, IN PLASTICA**

CODICE	MINIMO VENDITA	D			COLORE	CODICE FORNITORE	U.M.	€
0521141	50	1/2			Rosso	AF595	NR	1,056
0521142	50	1/2			Blu	AF596	NR	1,056

**STAFFA DI FISSAGGIO A MURO, IN ACCIAIO TROPICALIZZATO**

CODICE	MINIMO VENDITA	L	I	I'	H	CODICE FORNITORE	U.M.	€
0520963	10	330	280	50	37	AF629	NR	1,706

**CLIP DI FISSAGGIO IN PLASTICA**

CODICE	MINIMO VENDITA	D				CODICE FORNITORE	U.M.	€
0520942	50	10				AF583	NR	0,103
0520943	50	15				AF581	NR	0,239
0520944	50	22				AF582	NR	0,253
0520945	50	28				AF781	NR	0,781

**DISTANZIATORE PER CLIP**

0625553	20	15				AF600	NR	1,327
0625554	20	22-28				AF601	NR	1,327

9

## ACCESSORI PER SISTEMI AD INNESTO RAPIDO

## SILICONE LUBRIFICANTE, SPRAY 400 ML



CODICE	MINIMO VENDITA	D				CODICE FORNITORE	U.M.	€
0520958	1					AF674	NR	22,328

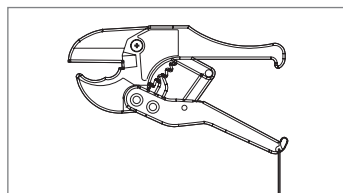

## CESOIA TRONCATUBO

0520941	1	10-28				AF579	NR	39,933
---------	---	-------	--	--	--	-------	----	--------

## SIFONI DI SCARICO SALVASPAZIO

## SIFONE DI SCARICO, IN PLASTICA

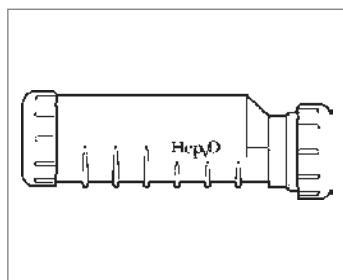

CODICE	MINIMO VENDITA	D		COLORE	CODICE FORNITORE	U.M.	€
0521121	10	32 mm		Bianco	AF3210M	NR	22,577
0521122	10	40 mm		Bianco	AF3211M	NR	25,076

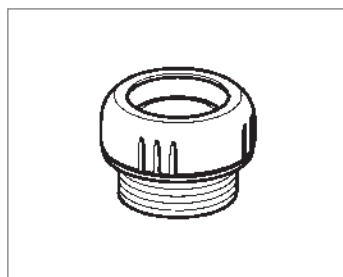

## ADATTATORE DRITTO, IN PLASTICA

0521117	10	32 mm		Bianco	AF3215M	NR	5,789
0521118	10	40 mm		Bianco	AF3216M	NR	6,014

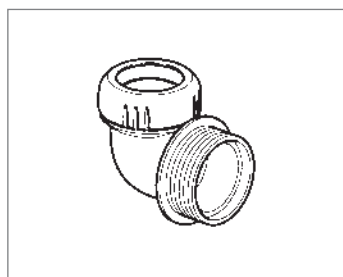

## ADATTATORE CURVO, IN PLASTICA

0521119	10	32 mm		Bianco	AF3217	NR	6,543
0521120	10	40 mm		Bianco	AF3218	NR	6,543